

ThinkSystem Micro DataCenter 12U 1200mm Deep Rack Cabinet Unpacking Instructions



ThinkSystem Micro DataCenter 12U Rack Cabinet Unpacking Instructions

This document provides instruction of unpacking the rack cabinet.

Requirements

See this section for space and tools required to unpack and install the rack cabinet.

S037



CAUTION:

The weight of this part or unit is more than 55 kg (121.2 lb). It takes specially trained persons, a lifting device, or both to safely lift this part or unit.

Space

You will need minimum of 3 m (10 ft) in front of the rear side of the pallet to unpack the rack cabinet.

Tools

- One 13-mm open-ended wrench
- One 13-mm socket wrench
- When moving the cabinet with a crane lifter:
 - One crane lifter
 - Four rated M10 lifting eye bolts with minimal bearable weight of 142 kg (312 lb)

Remove the packing materials

Follow the instructions in this section to remove the packing materials.

Note: Save the packing materials for later use, or recycle them.

Complete the following steps to remove the protective packaging from the rack cabinet:

Step 1. Cut the three plastic pallet straps that secure the cabinet.

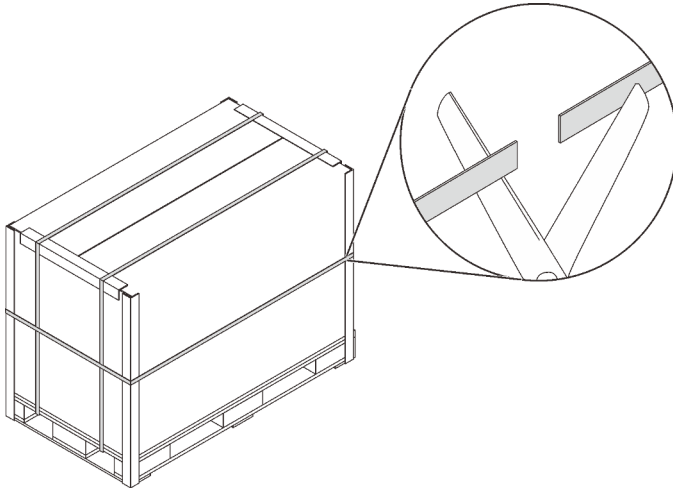

Figure 1. Cutting the plastic straps

Step 2. Remove the cardboard box, two side bars and the four corner clips.

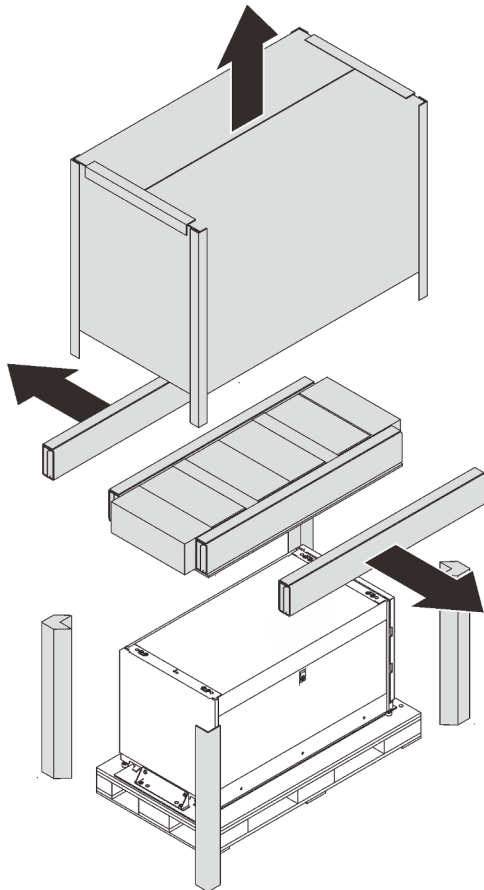

Figure 2. Removing the packing materials

Step 3. Grab and lift the plastic cover to remove it from the cabinet.

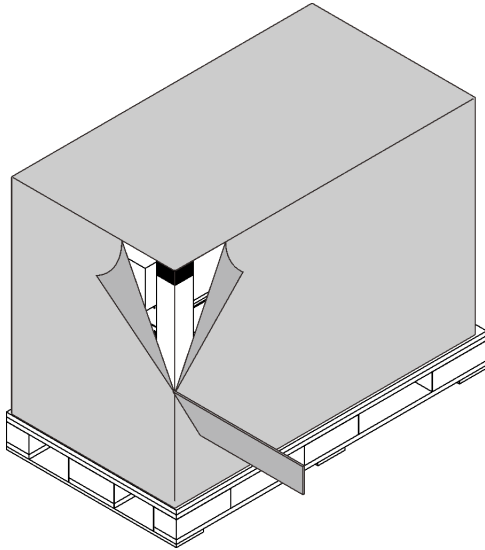

Figure 3. Removing the plastic cover

Identify rack cabinet components and tools Parts Listing

Identify each of the components that included in the box that contains the rack cabinet.

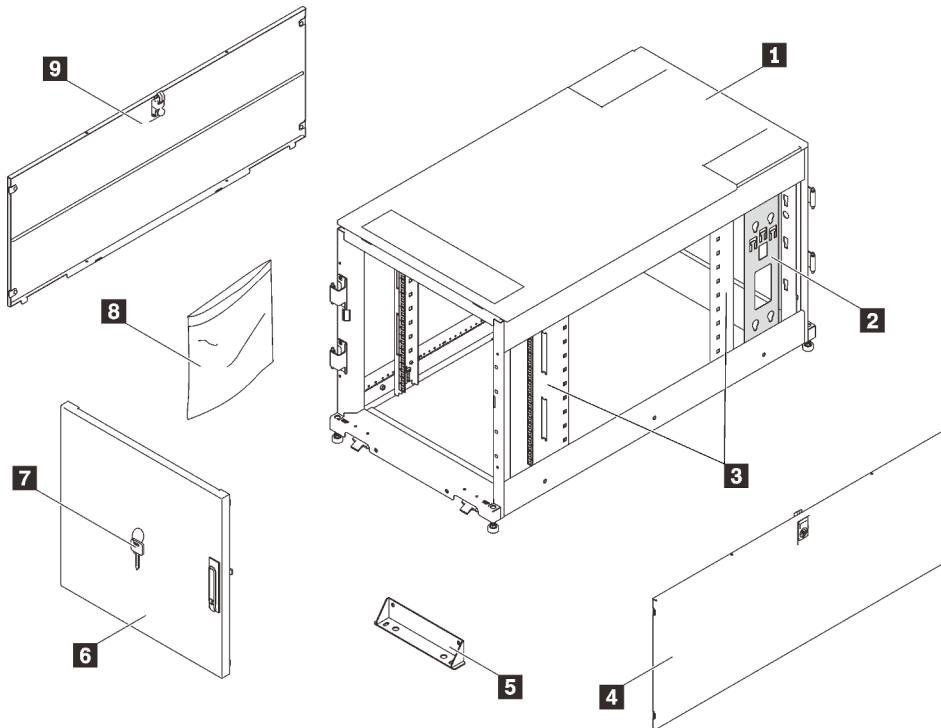

Figure 4. Rack cabinet components

Table 1. Rack cabinet components

1 Rack cabinet frame	6 Removable and reversible door
2 Rear cable flanges	7 Key

Table 1. Rack cabinet components (continued)

3 Vertical mounting flanges	8 Hardware bag (see “Hardware bag” on page 4)
4 Removable side panel	9 Removable side panel
5 Bolt-down bracket	

Hardware bag

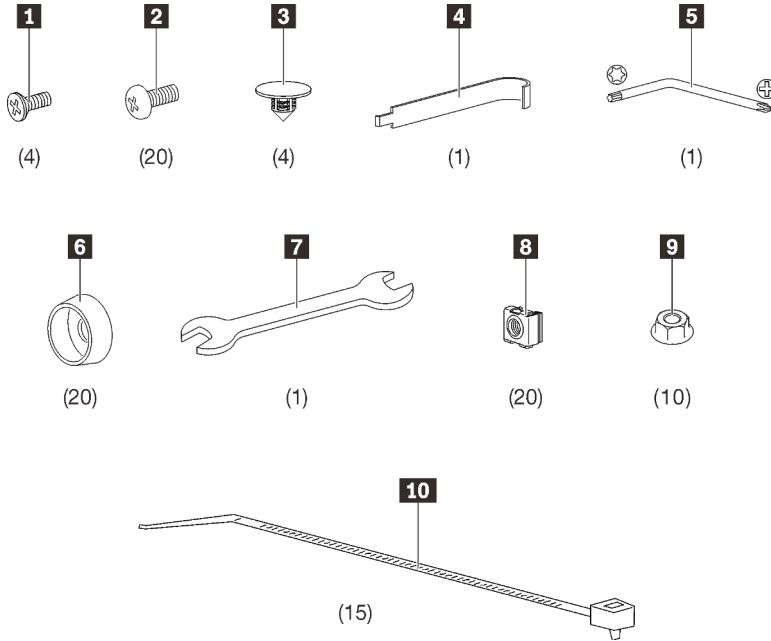

Figure 5. Components in the hardware bag

Table 2. Components in the hardware bag

1 Four M5x12 screws	6 20 plastic cup washers
2 20 M6x16 screws	7 One 13mm/14mm wrench
3 Four hole plugs	8 20 cage nuts
4 One cage nut tool	9 Ten flange nuts
5 One T30/#2 Phillips wrench	10 15 cable straps

Move the rack cabinet

Follow the instructions in this section to move the rack cabinet to the designated site.

S037



CAUTION:

The weight of this part or unit is more than 55 kg (121.2 lb). It takes specially trained persons, a lifting device, or both to safely lift this part or unit.



Attention - Tip hazard.

Important:

- The task in this section requires more than two people.
- The cabinet could be easily tipped. Move it with extreme caution.

WARNING: Failure to follow these instructions could result in equipment damage, severe injuries, or death.

Before moving the rack cabinet, complete the following steps:

1. Remove the screws that secure the bolt-down brackets on the front and rear side of the cabinet with the 13-mm socket wrench.

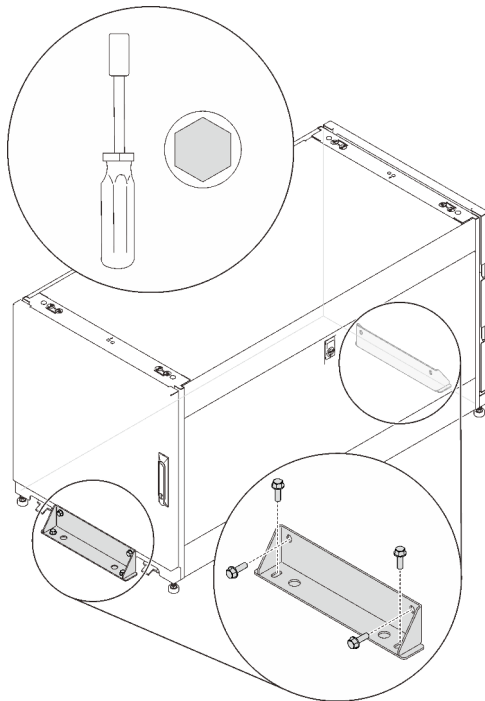

Figure 6. Removing the bolt-down brackets

Two options are available when moving the cabinet:

Casters

S037



CAUTION:

The weight of this part or unit is more than 55 kg (121.2 lb). It takes specially trained persons, a lifting device, or both to safely lift this part or unit.

Complete the following steps to lift and move the cabinet to the designated site:

Step 1. Remove the ramps from the box that is shipped with the cabinet, and install them on the front side of the pallet.

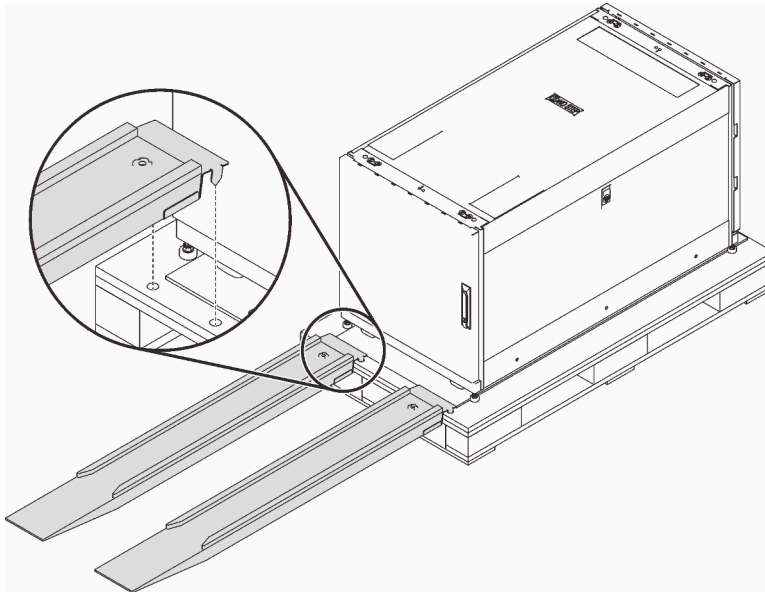

Figure 7. Installing the ramps

Step 2. Make sure the leveling feet are up. If not, insert a 13-mm open-ended wrench into the screw above one of the feet, and turn it counterclockwise until it no longer makes firm contact with the floor. Then, repeat this procedure on the other three feet.

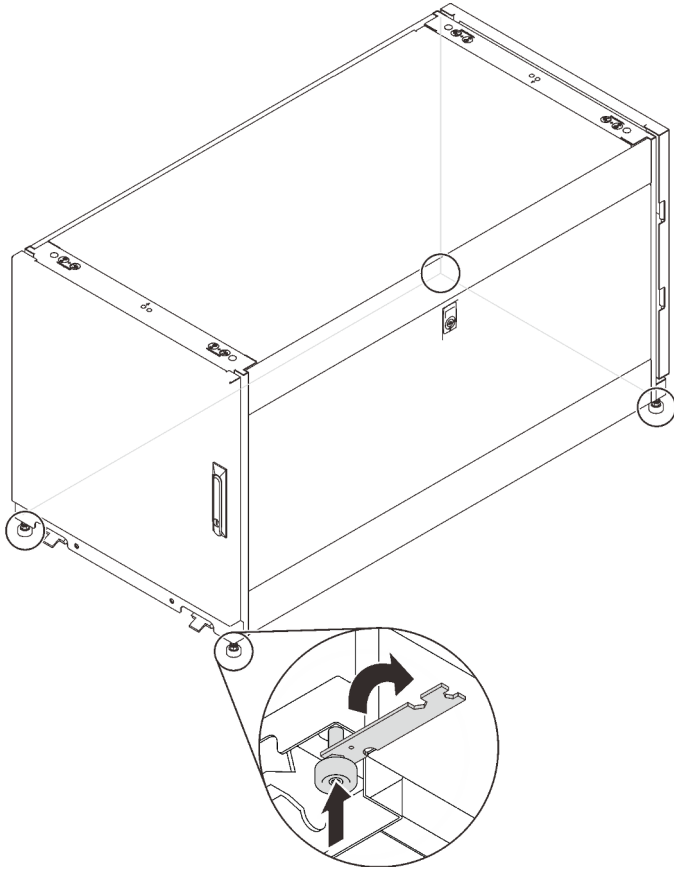

Figure 8. Adjusting the rack cabinet feet

Step 3. Push the cabinet from either the front or the rear until it reaches the designated site.

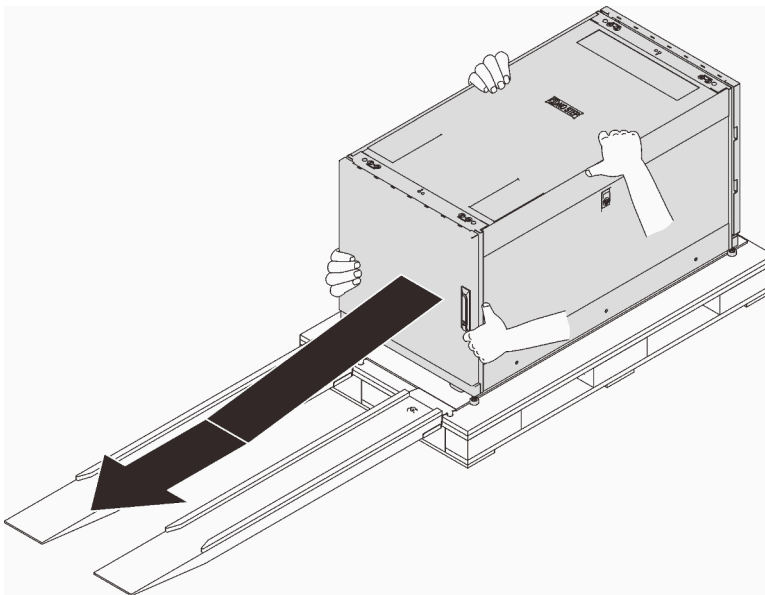

Figure 9. Sliding the cabinet down from the pallet

Notes:

- Make sure that more than two people are handling the cabinet while sliding it down from the ramps.
- Do not stand in the path of the rack.

Crane lifter



Attention - Drop hazard.

Complete the following steps to lift and move the cabinet to the designated site:

Step 1. Remove the four plugs from the four corners on the top of the cabinet frame.

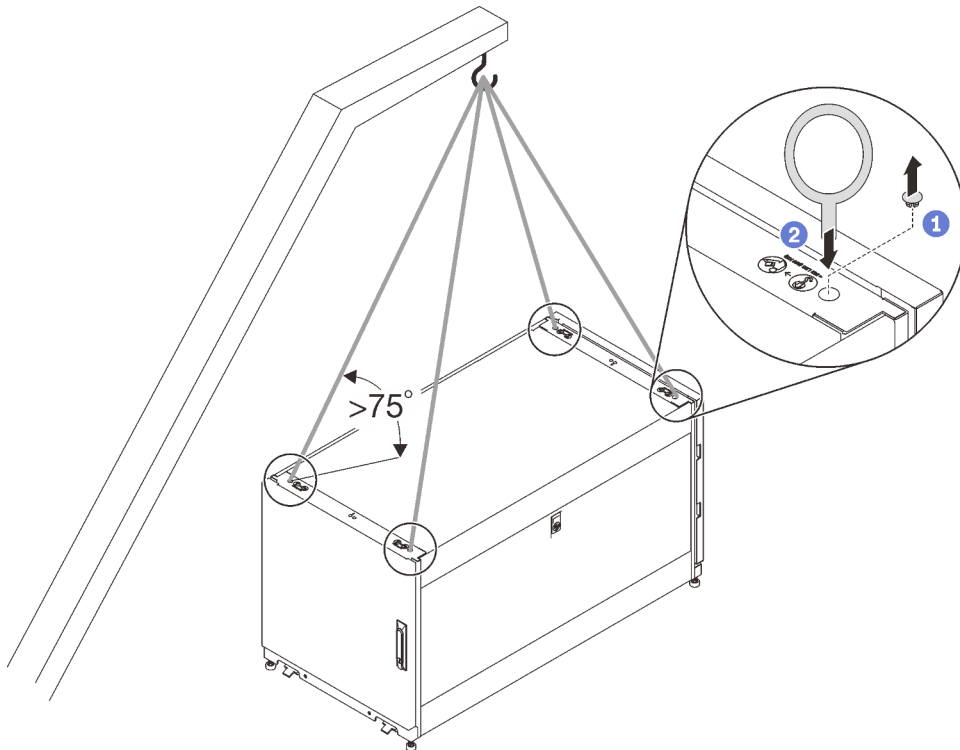

Figure 10. Lifting the rack cabinet

- Step 2. Install one M10 eye bolt to each hole, and make sure they stay solidly connected to the cabinet.
- Step 3. Connect the four eye bolts to the hook of a crane lifter, and make sure the cord length allows an angle more than 75° .
- Step 4. Lift the cabinet and place it to the designated site.

After moving the cabinet to the designated site, complete the following steps:

1. Make sure the leveling feet are down and make firm contact to the ground. If not, insert a 13-mm open-ended wrench into the screw above one of the feet, and turn it clockwise until the foot makes firm contact with the floor.

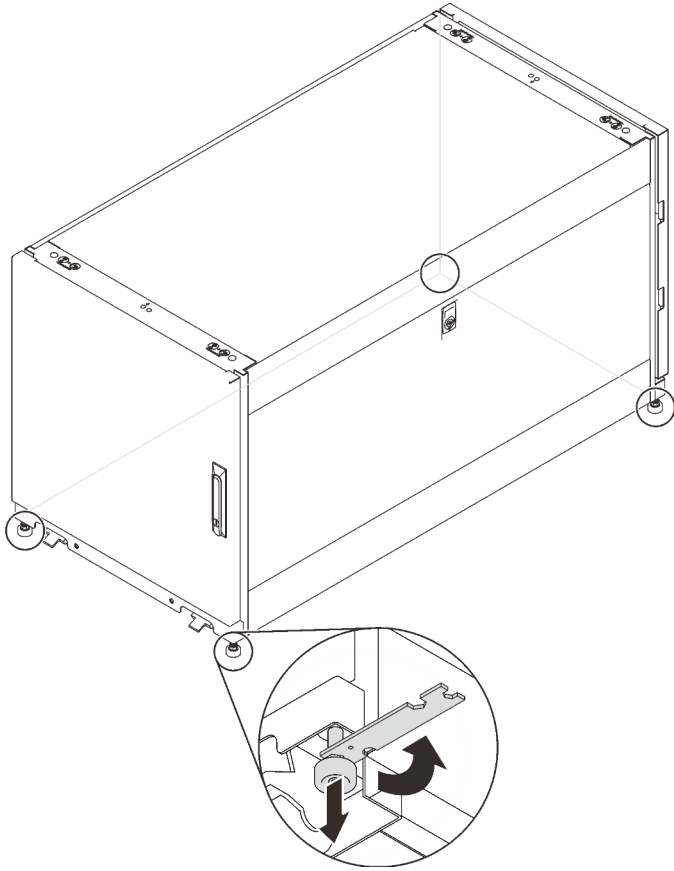

Figure 11. Adjusting rack cabinet feet

2. Repeat the same procedure on the other three feet until the cabinet is levelled with balance. To make sure the cabinet is balanced, slightly push the cabinet and make sure it does not shake or tilt.

Note: The leveling feet provide a stable base if the floor is slightly uneven, but they cannot compensate for a badly sloped surface.

3. Connect the grounding cable.

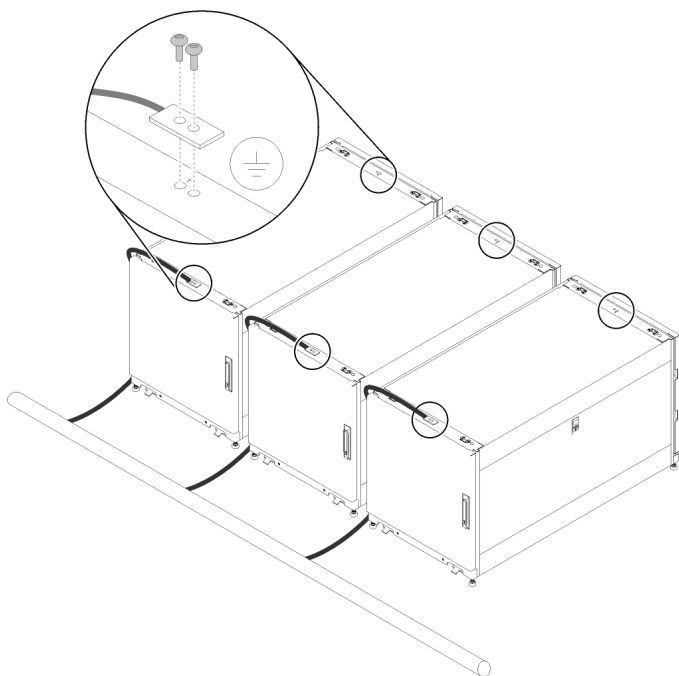

Figure 12. Connecting the grounding cable

4. To secure the cabinet to the ground, you can reinstall the bolt-down brackets that were removed earlier.

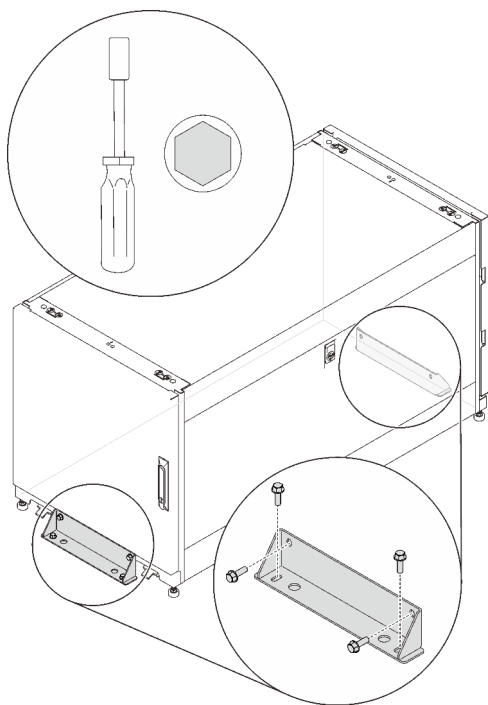

Figure 13. Installing the bolt-down brackets

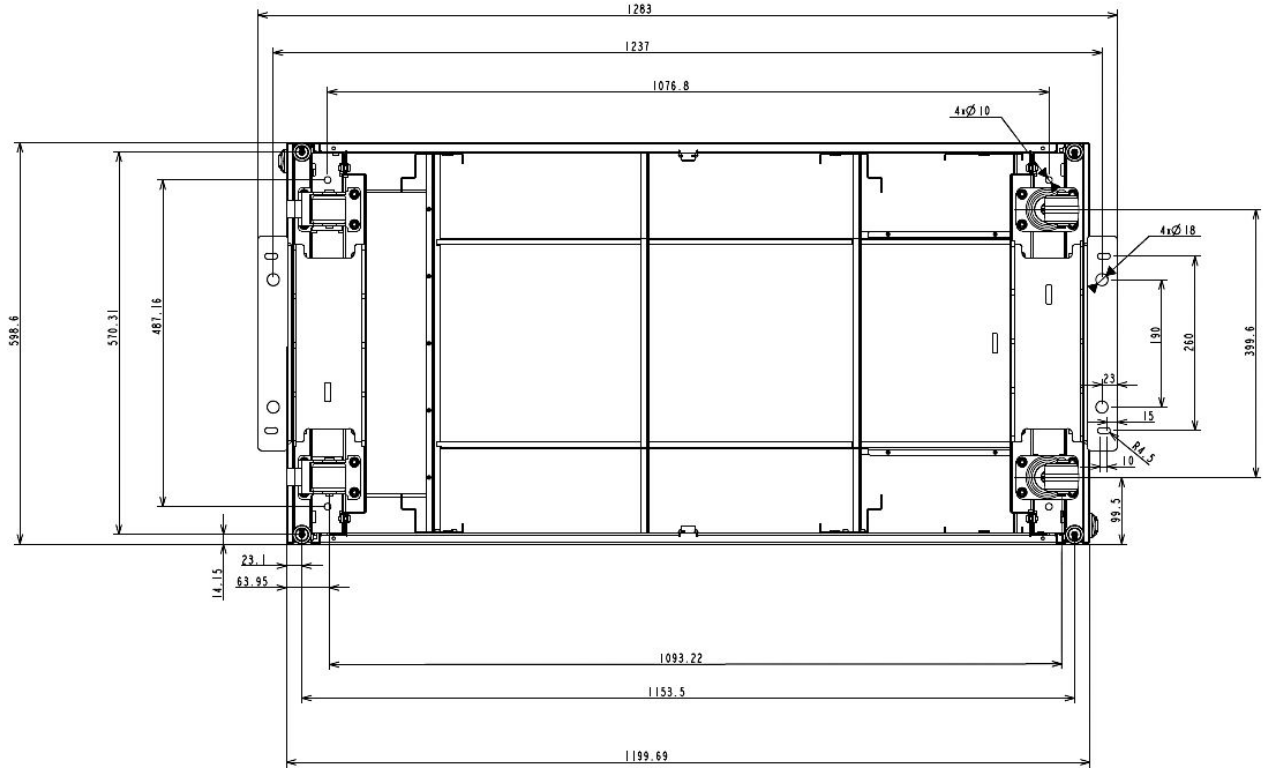

Figure 14. Rack cabinet with bolt-down brackets installed

Contacting support for door position monitor device

You can contact support to obtain help for the issues that are related to the door position monitor device.

Some cabinets might come with the following devices:

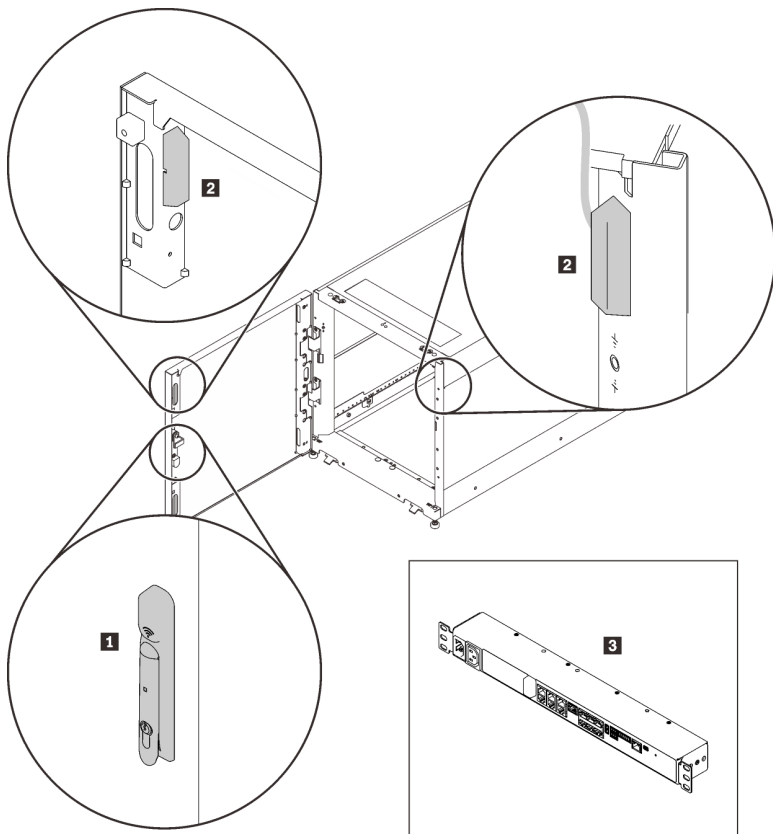

Figure 15. Door position monitor devices

- **1** Electronics lock
- **2** Door position monitor magnet and switch
- **3** Environmental monitoring appliance

In this case, contact the following for technical support and service with these devices.

- Phone number: +86-400-810-1315 (English/Chinese). Service hours: (UTC+8):

– **Monday-Friday:** 08:15-18:00

– **Saturday:** 09:00-17:00

- E-mail address: itbtech.support@schneider-electric.com
- Service website: <https://www.schneider-electric.cn/zh/work/services/>

For more information, see <https://support.lenovo.com/docs/12u>.



First Edition (March 2020)

© Copyright Lenovo 2020.

Lenovo and the Lenovo logo are trademarks of Lenovo in the United States, other countries, or both. Other company, product, or service names may be trademarks or service marks of others.

LIMITED AND RESTRICTED RIGHTS NOTICE: If data or software is delivered pursuant to a General Services Administration (GSA) contract, use, reproduction, or disclosure is subject to restrictions set forth in Contract No. GS-35F-05925.

Printed in China
(1P) P/N: SP47A41856

