

Wall-mounting Configuration Guide

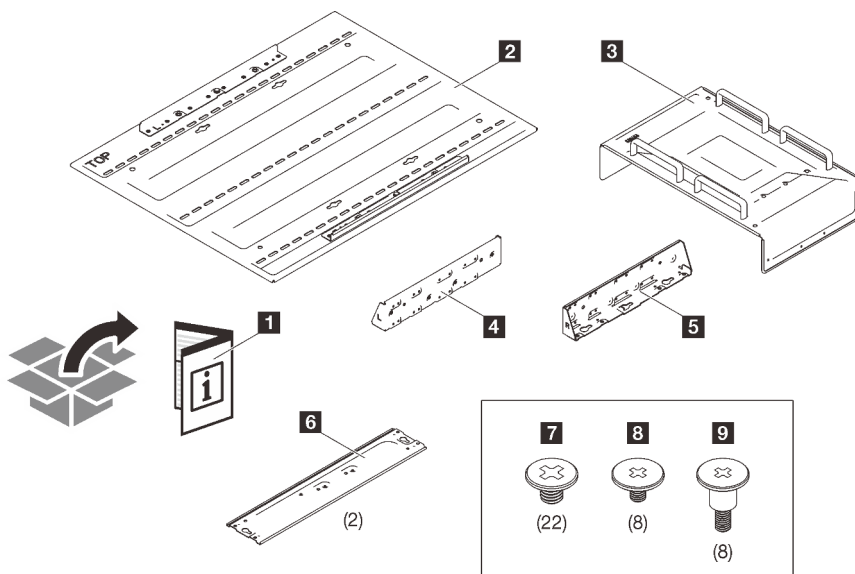

Attention:

- This kit must be installed by a qualified professional appointed by Lenovo Service. Severe personal injury and property damage can result from improper installation or assembly.
- Make sure this task is operated by two people with safe practices.
- The maximal weight of the server and wall mount assembly is 30 KG (66.14 lbs). For safe installation, the wall to mount the assembly must be able to support **4 times** of the assembly weight, 120 KG (264.55 lbs). If not, the surface must be reinforced to meet this standard.
- Avoid existing in-wall utilities, for example, plumbing, natural gas, or electrical input.



1 Document

2 Base plate

3 Top cover

4 Left L-shaped bracket

5 Right L-shaped bracket

6 Two bottom brackets

7 Twenty-two large M3 screws

8 Eight small M3 screws

9 Eight step screws

- Step 1. On the base plate, two mounting brackets are available for orientation. Keep the mounting bracket next to “TOP” on top as illustrated. Then, secure the base plate to the wall with at least six screws through the three rows of holes.

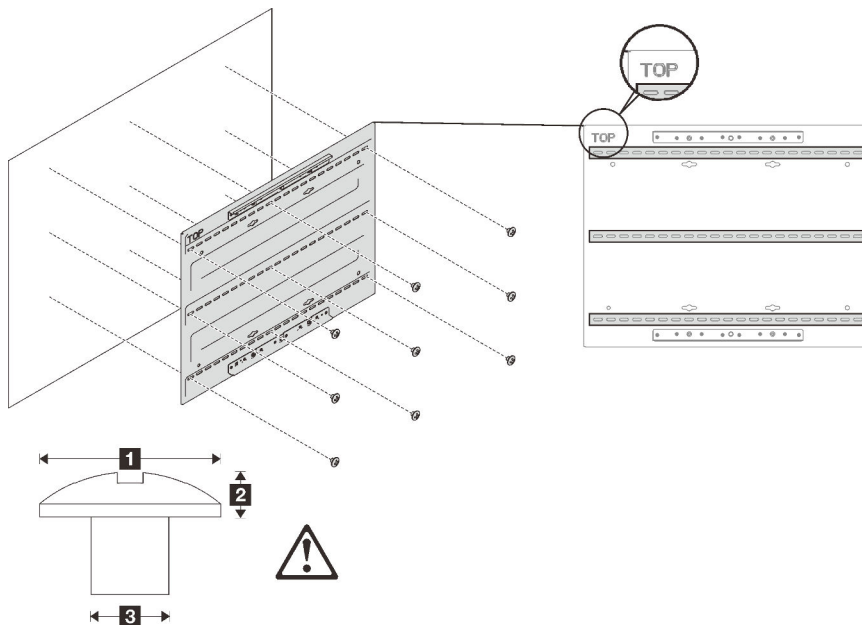

Table 1. Maximum screw size for installation

| | | |
|------------------|-----------------|-----------------|
| 1 Ø 14 mm | 2 3.5 mm | 3 Ø 6 mm |
|------------------|-----------------|-----------------|

Note: The appropriate length of the screw base should be assessed by qualified professionals.

- Step 2. Align the eight mounting pins on each side of the server with the holes on the L-shaped brackets as illustrated. Then, secure the brackets to the server with eight **small** M3 screws.

Note: The brackets come with L/R printing. Install “L” to the left-hand side of the server, and “R” to the right-hand side.

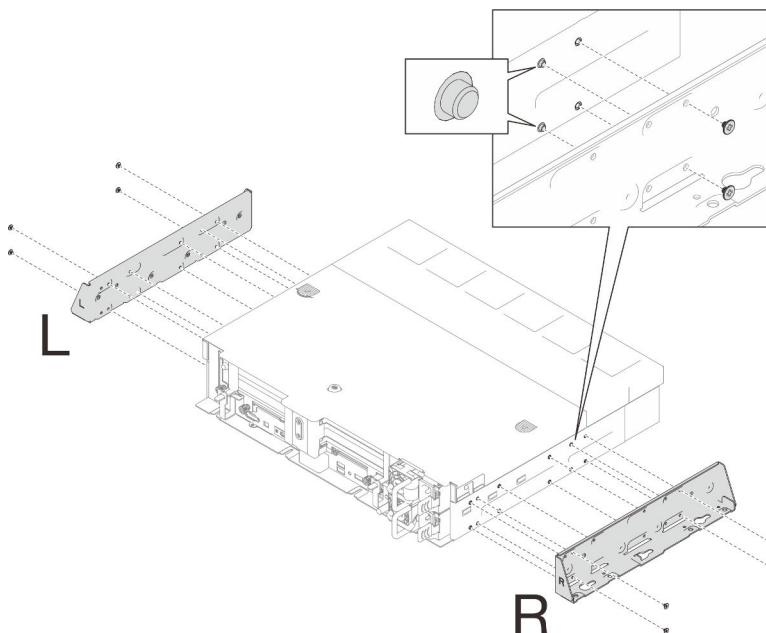

Step 3. Flip the server over, and align the four pins on the bottom of the server with the holes on the bottom brackets. Then, secure the bottom brackets to the server and the L-shaped brackets with fourteen **large M3 screws**.

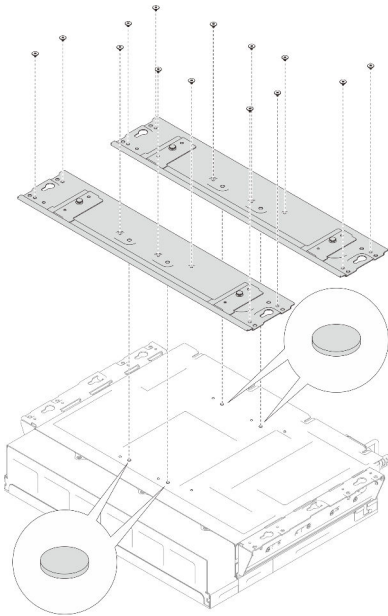

Step 4. Flip the server back, and place the top cover over the server-bracket assembly. Then, secure each side of the cover to the server with four **M3 large screws**.

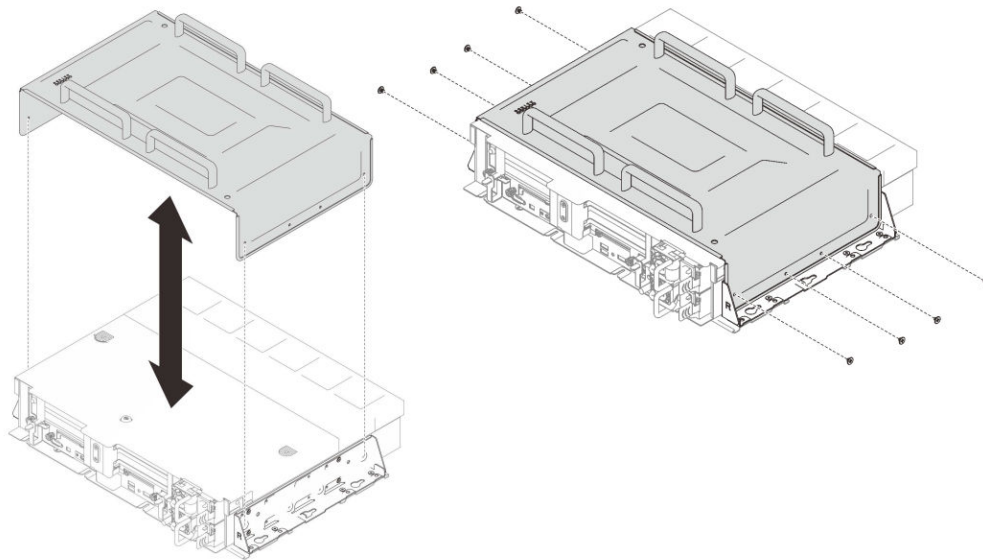

Step 5. Align the mounting holes on the L-shaped brackets with the pins of the upper and lower mounting brackets on the base plate, and slide the assembly slightly left until it stops. Then, Secure the assembly to both brackets on the base plate with eight step screws.

Attention:



Make sure this task is operated by two people with safe practices.

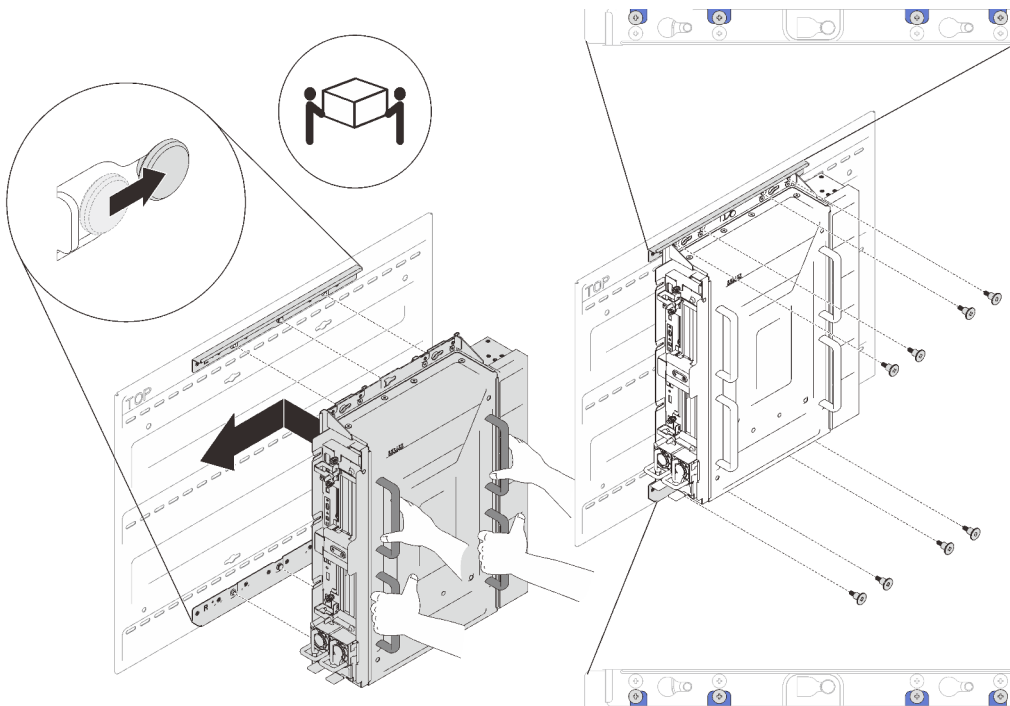

First Edition (April 2022)

© Copyright Lenovo 2022.

LIMITED AND RESTRICTED RIGHTS NOTICE: If data or software is delivered pursuant to a General Services Administration (GSA) contract, use, reproduction, or disclosure is subject to restrictions set forth in Contract No. GS-35F-05925.

Printed in China

(1P) P/N: SP47A76696

