

Rail Installation Guide

Rail kit parts inventory

The Rail Kit includes the following parts:

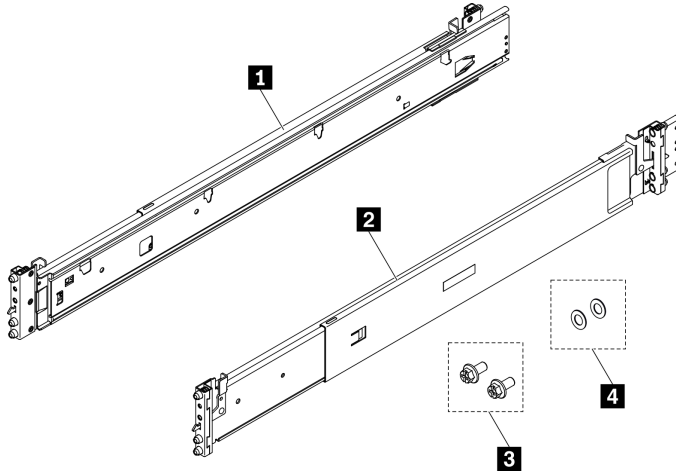

1 One left rail	3 Two M5 screws
2 One right rail	4 Two washers

Notes:

- This kit can be installed in both square hole and round hole rack.
- If any parts is missing, contact your local support.

Read these guidelines first

Read the following guidelines before installing the rail kit and system to the rack.

- The rail travel distance is 920 mm (36.22 inches)
- Install the system to a rack that meets the following requirements:
 - Minimum depth of 150 mm (5.91 inches) between the front mounting flanges and inside of the front door.
 - Minimum depth of 125 mm (4.92 inches) between the chassis rear wall and inside of the rear door.
 - The maximum distance between the front and rear mounting flanges is 812.8 mm (32.00 inches).
 - If you want to install the rails and a 0U PDU into the same rack, the rack must meet the following height and depth requirements:
 - 42U or higher
 - Without CMA: at least 1185-mm (46.65-inch) deep
 - Only install the system into a rack with perforated doors. Remove the rack doors and side panels for easy access during installation.
 - When installing multiple units, start with installing the heaviest device to the lowest part of the rack.
 - See the system *Maintenance Manual* or *Setup Guide* for the requirements of room air temperature.
 - Do not block any air vents. Spare at least 15 cm (6 inches) of space for proper airflow.

- Do not leave the unoccupied space above or below an installed system in the rack empty. To prevent damage to system components, always install filler panels to cover unoccupied space to ensure proper air circulation.
- Do not leave more than one system slid out from the rack at the same time.
- Do not overload the power outlet when multiple devices are installed in the rack.

S036



18 - 32 kg (39 - 70 lb)



32 - 55 kg (70 - 121 lb)

R006



CAUTION:
Do not place any object on top of a rack-mounted device unless that rack-mounted device is intended for use as a shelf.

Install the rail kit to the rack

Note: The rails are extensible as shown in the following illustration.

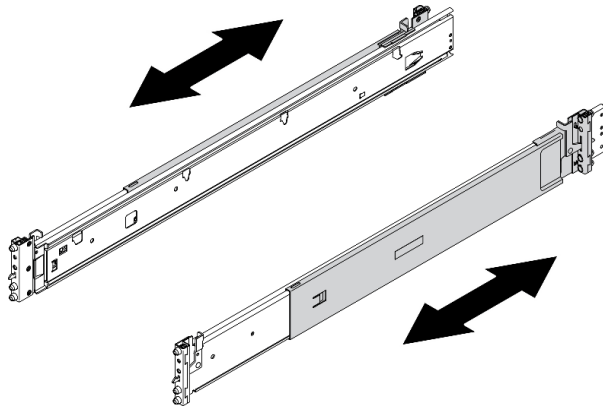

- Step 1. Select the first rail you want to install.
- Step 2. Make sure the rail is shortened to the shortest position.
- Step 3. Install the rail to the rack, starting from the rear and proceeding to the front.

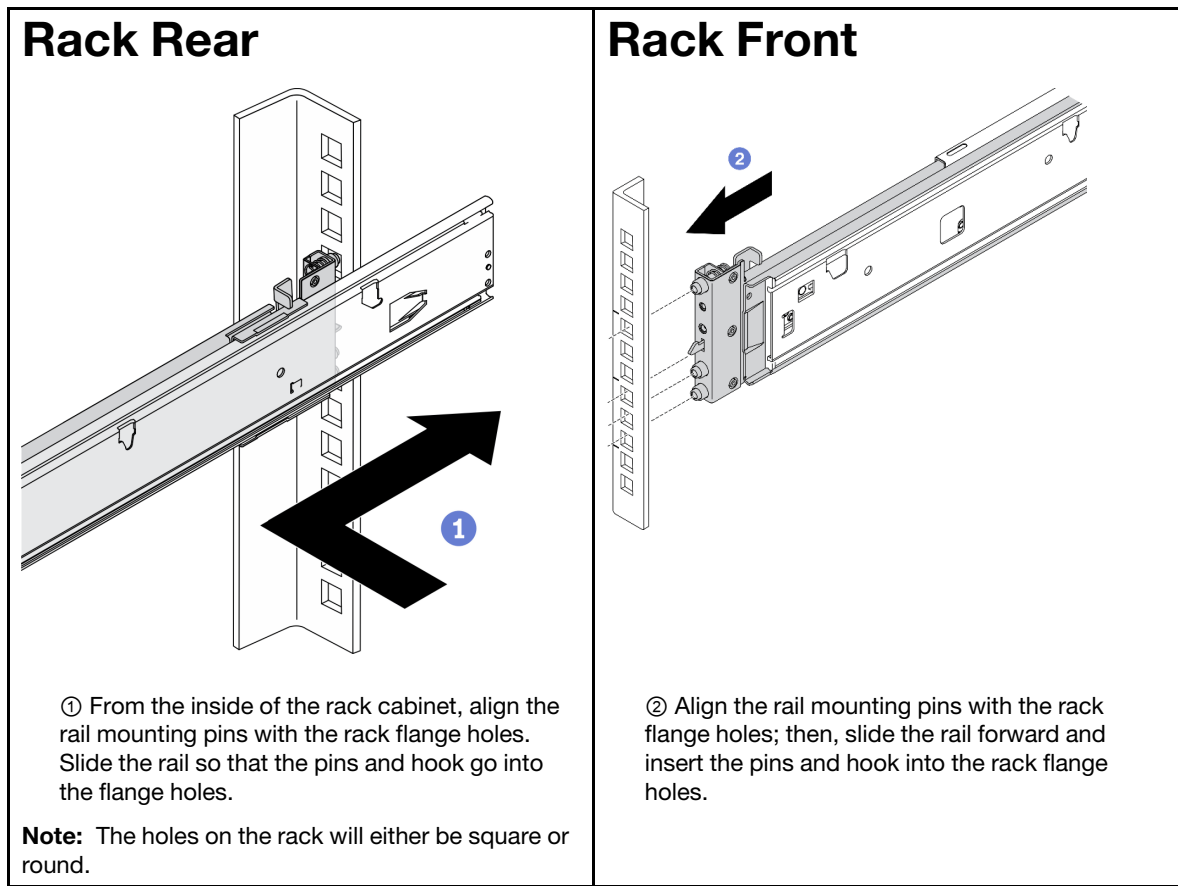

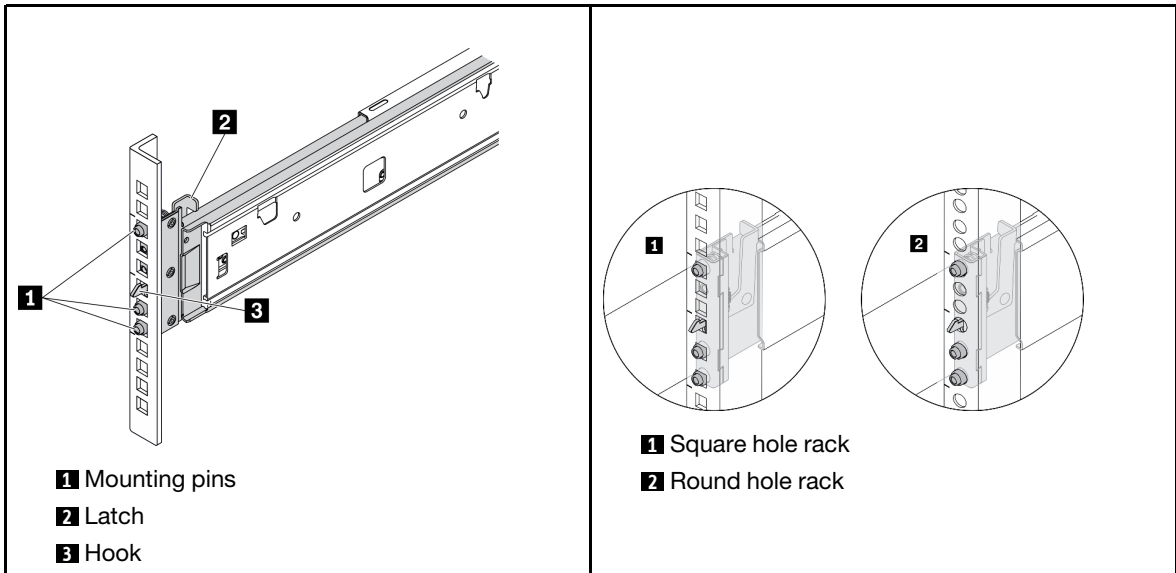

- Step 4. Make sure that the rail is securely engaged in the flange holes by inspecting that the hook has caught and by sliding back and forward to ensure the rail does not pop out.
- Step 5. Repeat Step 2 to Step 4 to install the other rail.
- Step 6. Proceed to server installation. See the system *Maintenance Manual* or *Setup Guide*.

Remove the rails from the rack

- Step 1. Remove the server from the rails. See the system *Maintenance Manual* or *Setup Guide*.
- Step 2. If the rails are secured to the rear of the rack, unfasten the screws to disengage the rails from rack.
- Step 3. Remove the rails from the rack.

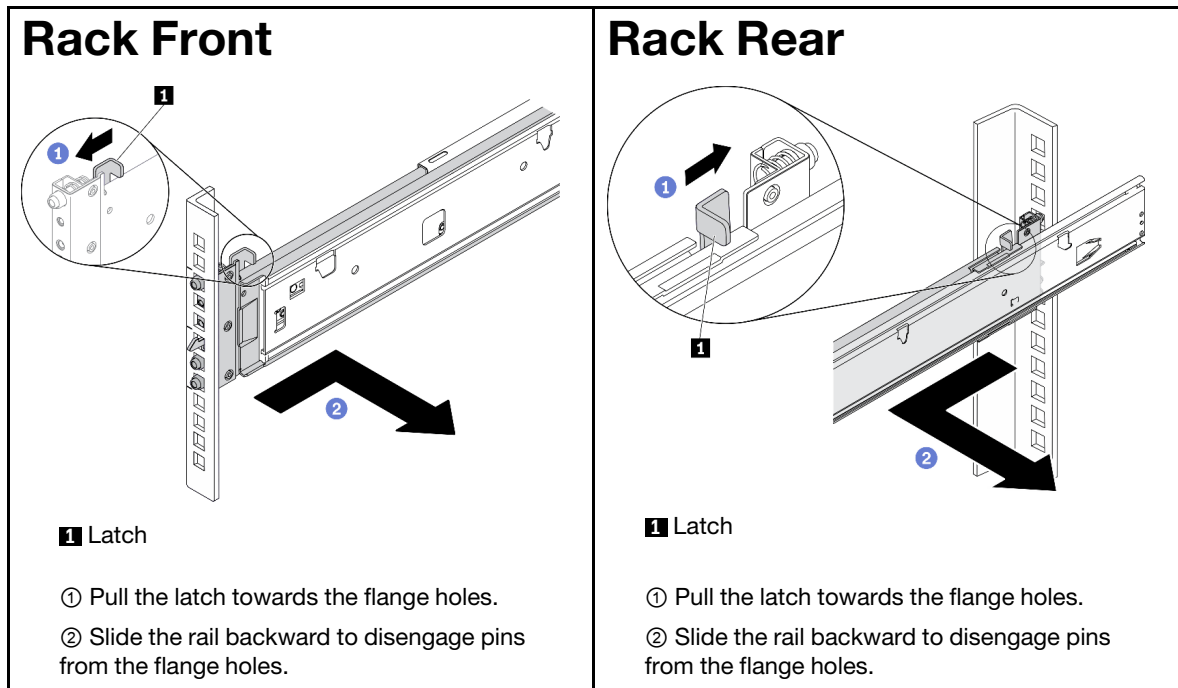

First Edition (May 2021)

© Copyright .