

# Rail Installation Guide

---

## Rail kit parts inventory

The Toolless Rail Kit includes the following parts:

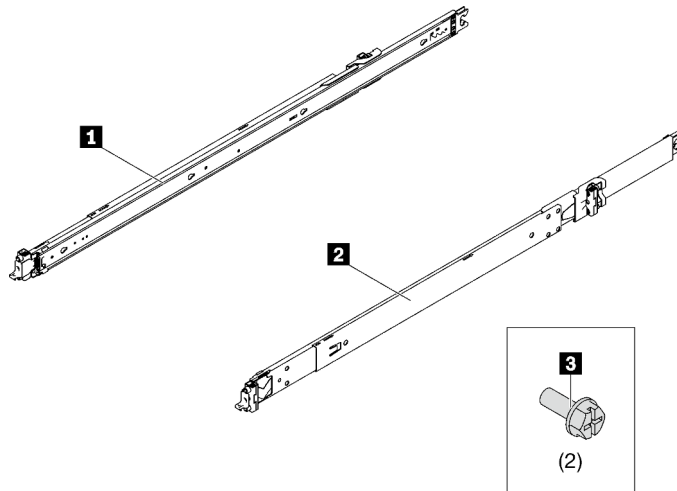

- 1** One left rail
- 2** One right rail
- 3** Two M6 screws

**Notes:**

- This kit can be installed in both square hole and round hole rack.
- If any parts are missing, contact local service.

## Read these guidelines first

Read the following guidelines before installing the rail kit and server to the rack.

- The maximum rail travel distance is 931 mm (36.65 inches).
- Install the server to a rack that meets the following requirements:
  - Minimum depth of 70 mm (2.76 inches) between the front mounting flanges and inside of the front door.
  - Minimum depth of 1008 mm (39.60 inches) between the front mounting flanges and inside of the rear door.
  - The maximum distance between the front and rear mounting flanges is 812.80 mm (32.00 inches).
  - To install the rails and a 0U PDU into the same rack, the rack must meet the following height and depth requirements:
    - 42U or higher
    - Without CMA: at least 1100-mm (43.31-inch) deep
    - With CMA: at least 1100-mm (43.31-inch) deep
  - Only install the server into a rack with perforated doors. Remove the rack doors and side panels for easy access during installation.
  - When installing multiple units, start with installing the heaviest device to the lowest part of the rack.
  - See the *User Guide* for the requirements of room air temperature.
  - Do not block any air vents. Spare at least 15 cm (6 inches) of space for proper airflow.
  - Do not leave the unoccupied space above or below an installed server in the rack empty. To prevent damage to server components, always install filler panels to cover unoccupied space to ensure proper air circulation.
  - Do not leave more than one server slid out from the rack at the same time.

– Do not overload the power outlet when multiple devices are installed in the rack.

If you need to remove the rail from rack, refer to the “Hardware replacement procedures” chapter in the server *User Guide*. Search your server and select its *User Guide* at Lenovo server product portfolio page: <https://pubs.lenovo.com/>.



### **S036**



18 - 32 kg (39 - 70 lb)



32 - 55 kg (70 - 121 lb)

**CAUTION:**  
Use safe practices when lifting.

### **R006**



**CAUTION:**  
Do not place any object on top of a rack-mounted device unless that rack-mounted device is intended for use as a shelf.

### **S037**



**CAUTION:**  
The weight of this part or unit is more than 55 kg (121.2 lb). It takes specially trained persons, a lifting device, or both to safely lift this part or unit.

## **Install the rail kit to the rack**

**Important:** Make sure both ends of the rail are seated at the same height.

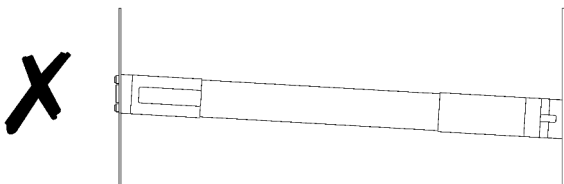
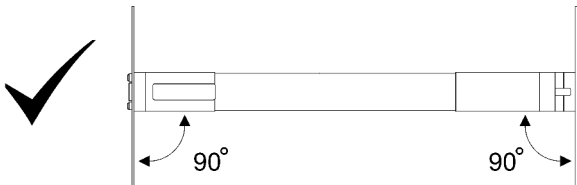

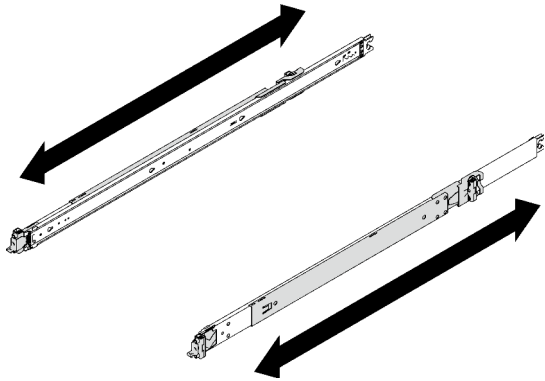

**Notes:**

- The rails are extendable as shown in the following illustration.
- Install the rail to the rack, starting from the rear and proceeding to the front.
- Make sure the rail is shortened to the shortest position.
- The rail mounting pins take up 1U space. Follow the U space marking on the rack when installing the rail kit.

Step 1. Install the rear mounting pins to the rack.

<h2 style="margin: 0;">Rear</h2>	
	 Square hole rack   Round hole rack
<ol style="list-style-type: none"> <li>1 Extend the outer rail toward the rear mounting flanges in the rack.</li> <li>2 Align the mounting pins with the rear mounting flanges and set the opening of the rear latch against the rack frame.</li> <li>3 Push the rail toward outside of the rack until the rear latch opens.</li> <li>4 Push the rail toward the rear mounting flanges until the rear latch rotates back to the closed position.</li> </ol>	

Step 2. Install the front mounting pins to the rack.

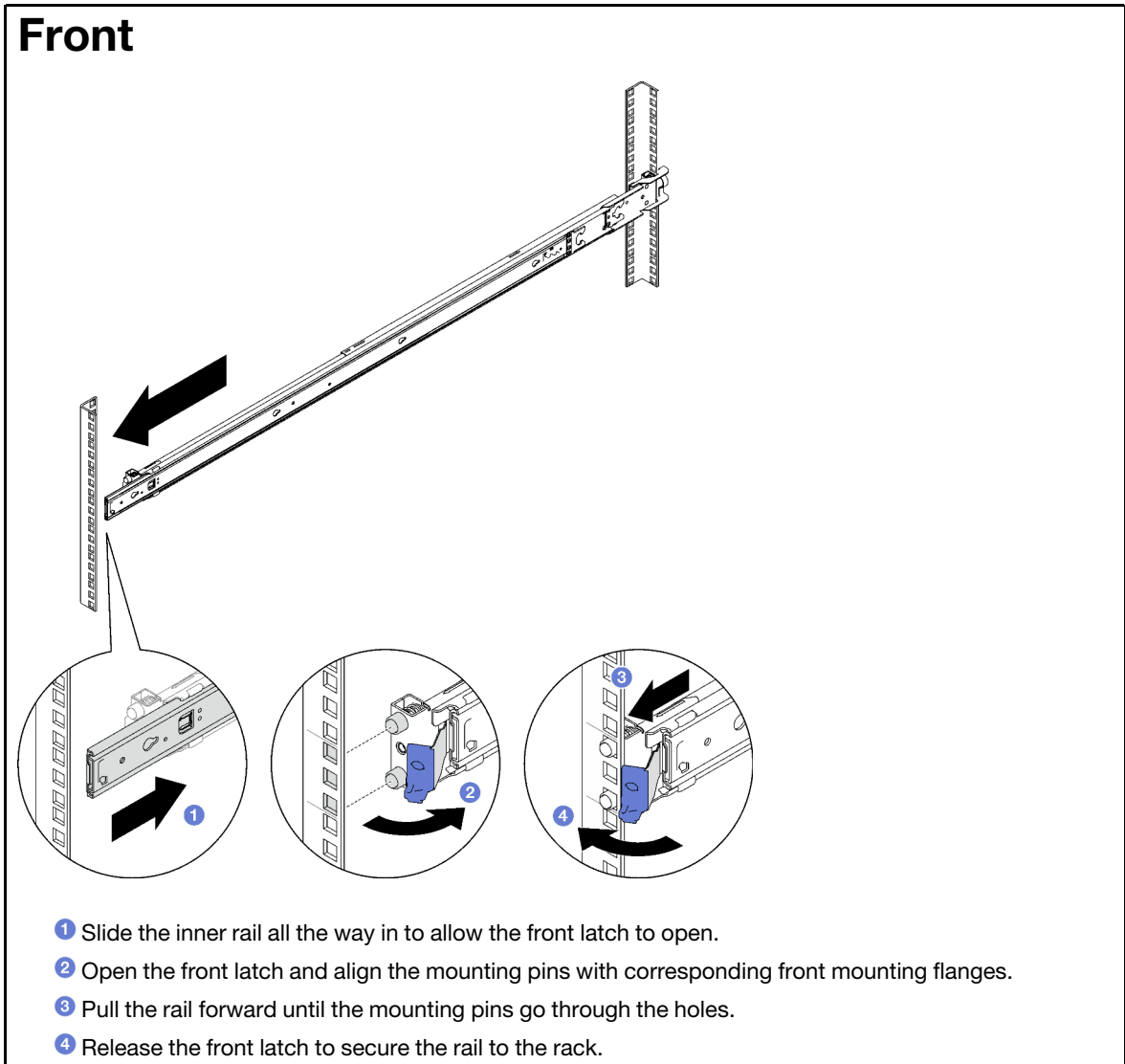

Step 3. Repeat the previous two steps on the other rail.

## Install the server to rails

Step 1. Lift the server and place it on a table. Two lifting options are available:



For two-person lift, remove the following components beforehand:

- All the power supply units
- All the storage drives



Otherwise, lift the server with three people or a lifting device.

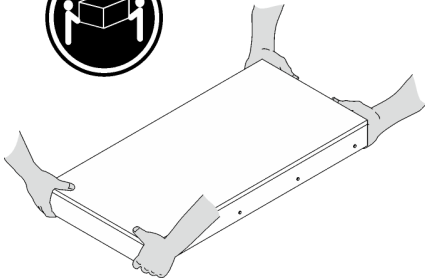

**CAUTION:**

**Make sure two people are lifting the server with hands positioned as illustrated.**

Step 2. Remove the inner rails from the intermediate rails.

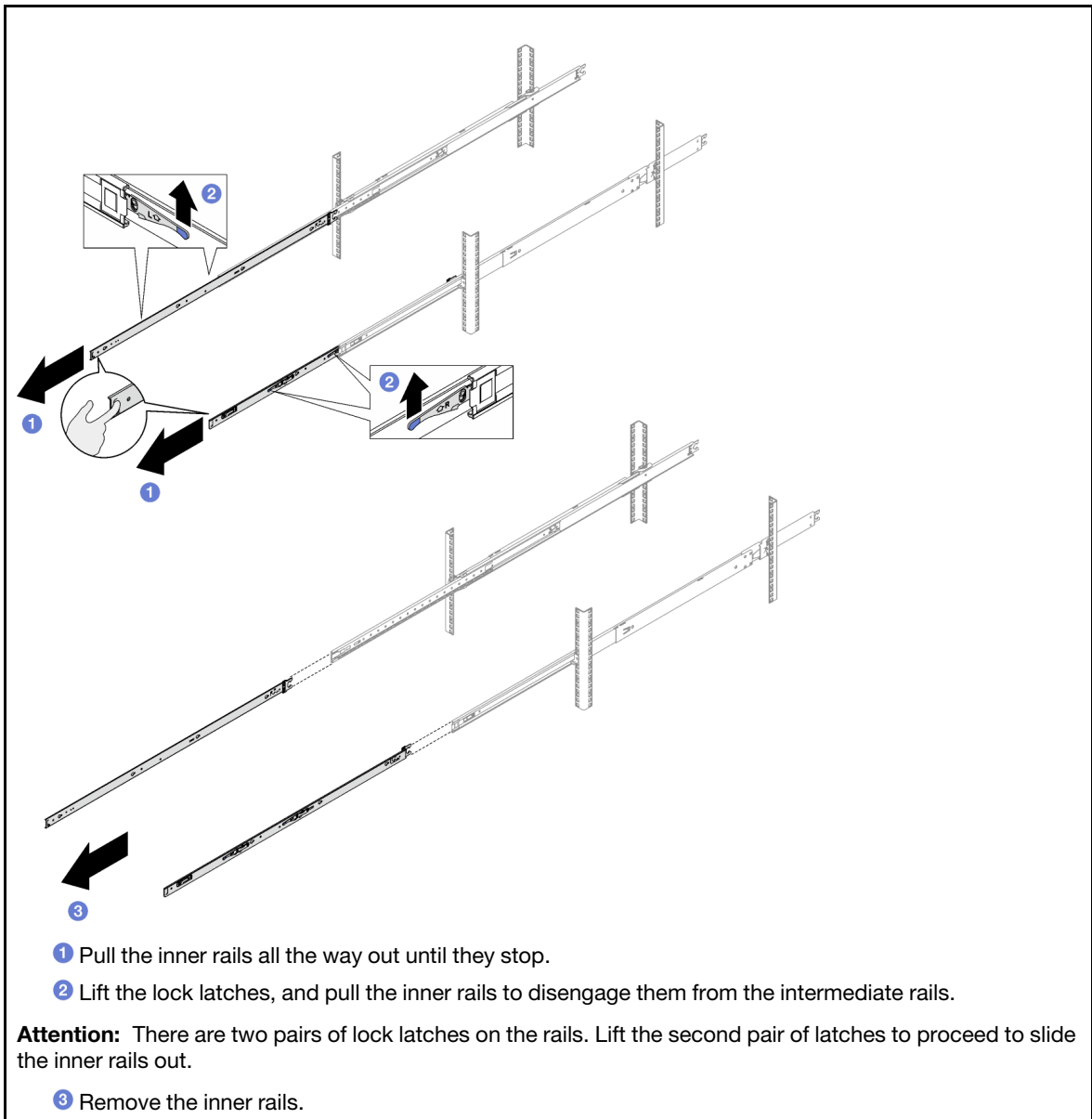

Step 3. Align the slots on the inner rail with the corresponding T-pins on the side of the server; then, slide the inner rail forwards until the T-pins lock into place with the inner rail.

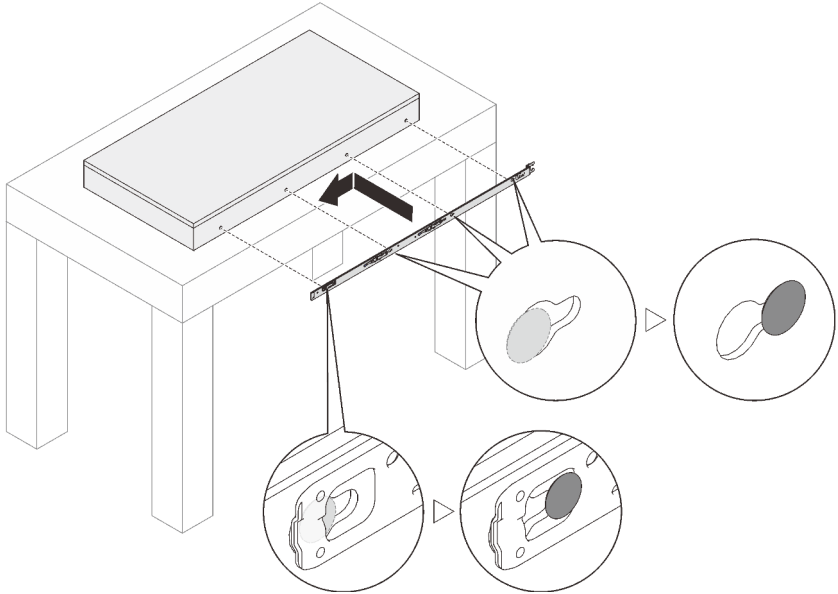
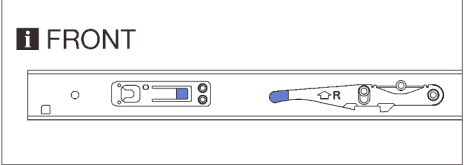

Step 4. Repeat the previous step on the other rail.

Step 5. Install the server to the rack.

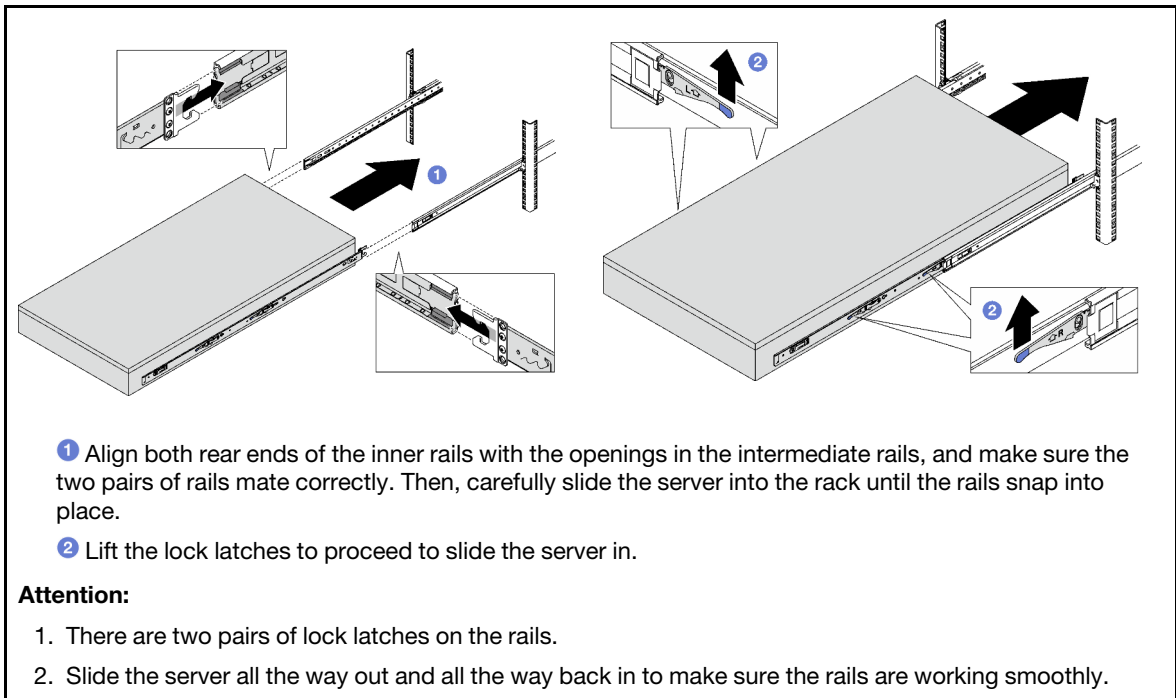

Step 6. Reinstall all the components that were removed previously.

## (Optional) Secure the server to the rack

Step 1. Secure the server to the rack.

**Attention:** Make sure to secure the screws when shipping on rack.

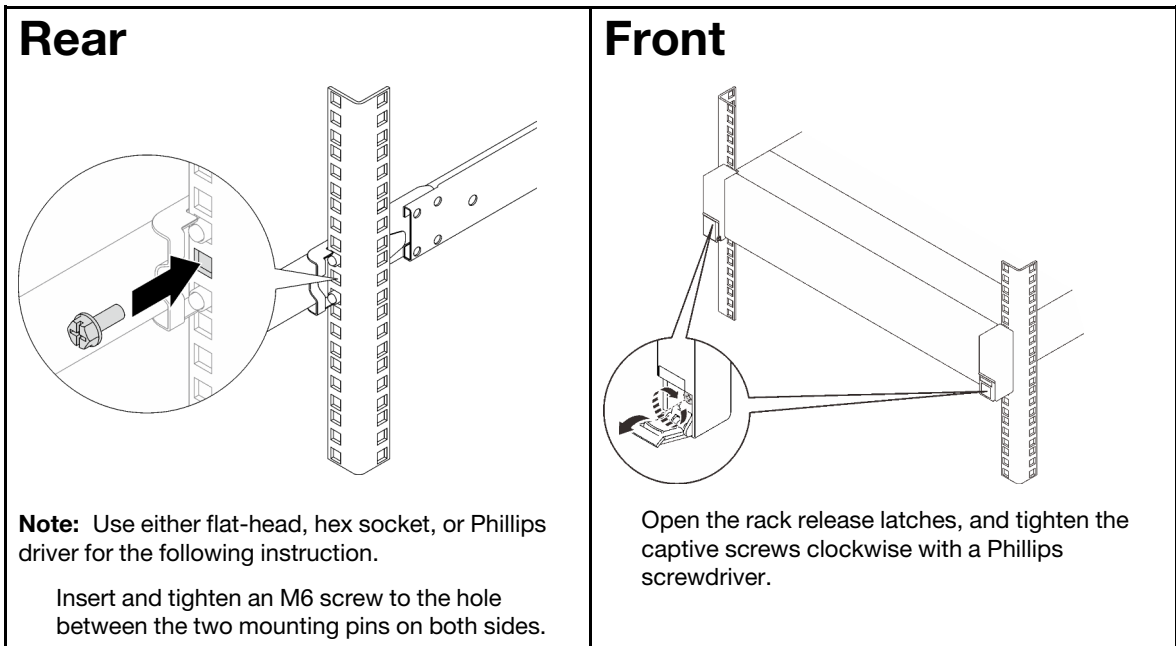





---

**First Edition (May 2023)**

**© Copyright Lenovo 2023.**

LIMITED AND RESTRICTED RIGHTS NOTICE: If data or software is delivered pursuant to a General Services Administration (GSA) contract, use, reproduction, or disclosure is subject to restrictions set forth in Contract No. GS-35F-05925.

Printed in China  
(1P) P/N: 1PSP47B37780

